

MEDICAL WATER FILTERS

MSF/MTF SC92 SERIES

Installation and operating instructions

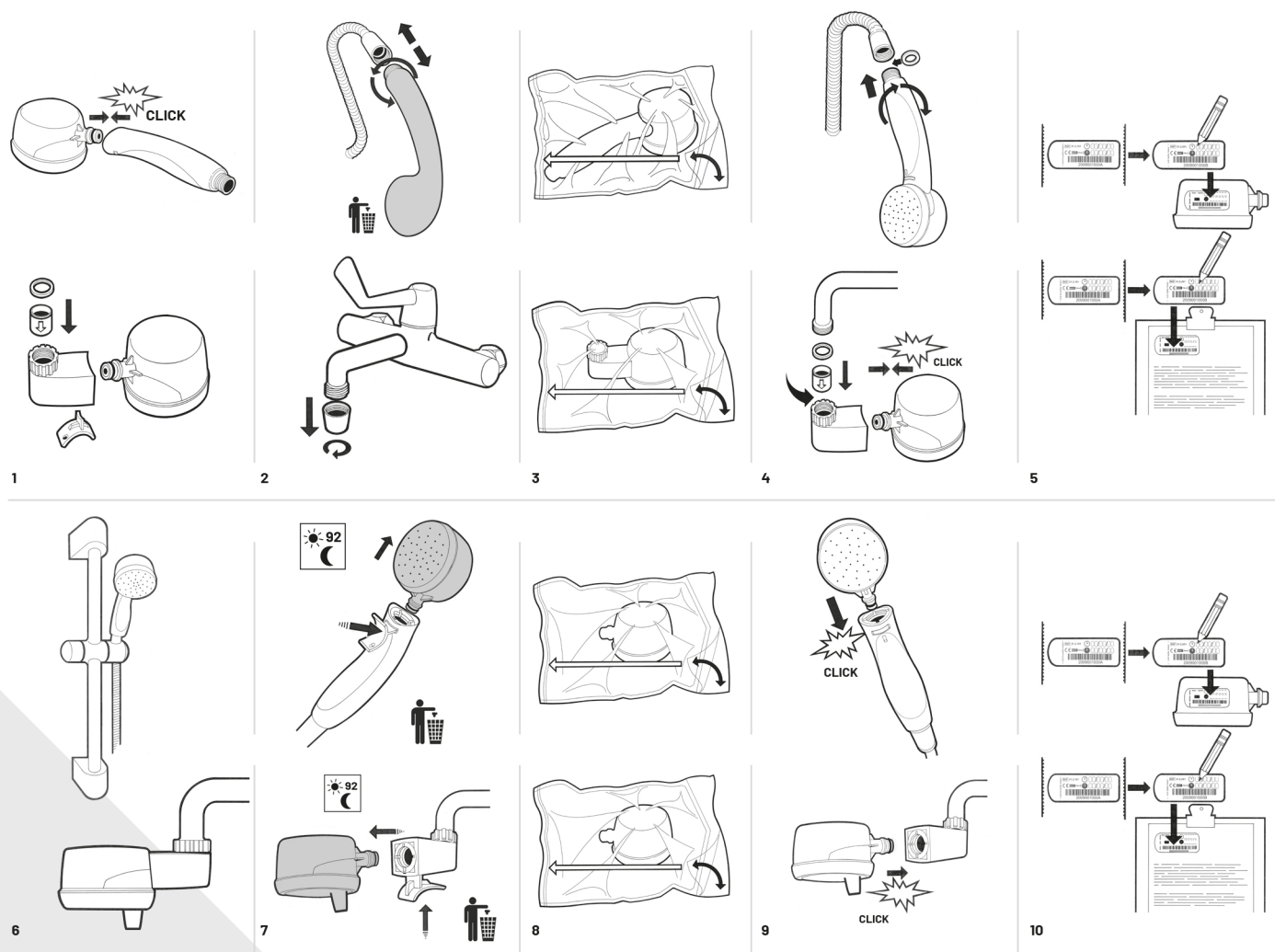

INTRODUCTION

Thank you for choosing a Pentair Medical Filter. The Pentair Medical Filters come with a membrane module that has been validated for the removal of specific bacteria that occur in the water supply system. The filters can be used for personal hygiene in hospitals, such as showers, and for washing your hands. The filter must be replaced 92 days after its first use. The service life of the filter cannot be extended by not using it temporarily. After use the filter cannot be sterilised in an autoclave or by means of any other sterilisation technique. For more details about performance and the usage and storage conditions, please refer to the relevant product data sheet on our website www.x-flow.com.

IMPORTANT PRECAUTIONS AND INSTRUCTIONS

The product is suitable only for connection to a cold-water or mixing-water facility. The maximum allowable operating temperature is 60 °C (140 °F). The maximum allowable operating pressure of the filter system is 5 bar (72.5 psi). Contact your water supplier or your technical department for information about the current water pressure. Make sure that the filter system is connected correctly by carefully following these operating instructions. Do not use if the package has been damaged, or after the expiry date has passed. We recommend washing your hands thoroughly before installation. Avoid contact with the outlet opening of the filter as much as possible to prevent bacterial contamination. During periodic disinfection of the water supply system, the filter basically does not have to be removed. Depending on the disinfection method used, the filter may have to be replaced afterwards. Please refer to the filter data sheet for this. Avoid exposure to temperatures below 0 °C after first use. Handle with care, do not expose to shocks. This may damage the filter material. When in doubt, we recommend placing a new filter cartridge.

INSTALLATION OF THE SHOWERFILTER

Follow the step-by-step plan on the backside page of these instructions to install the ShowerFilter (picture 1-6).

Where required, remove the existing shower head. Remove the ShowerFilter from the sterile packaging. Place the ShowerFilter on the end of the shower hose. The ShowerFilter comes standard with a ½" G (BSP) coupling (male). Make sure that the flat seal of the shower hose coupling is in the correct

position. Attach the watertight 2-part date label supplied to the filter and write down the date of first use and the replacement date (92 days later) on both labels. The top label is for your own administration. Attach the bottom label to the filter. If you have instrument management software the filter can be registered via the barcode. The ShowerFilter can now be put into use.

INSTALLATION OF THE TAPFILTER

Follow the step-by-step plan on the backside page of these instructions to install the TapFilter (picture 1-6).

Where required, remove the outlet piece of the tap. Remove the TapFilter from the sterile packaging. Fit the flow regulator in the designated opening. The arrow on the regulator indicates the flow direction. Press the regulator into place, and then fit the flat gasket. Screw the TapFilter onto the tap opening. The TapFilter comes standard with a 22-mm coupling (inner thread). An adapter for other sizes is available. Make sure that the flat seal of the coupling is in the correct position. Attach the watertight 2-part date label supplied to the filter and write down the date of first use and the replacement date (92 days later) on both labels. The top label is for your own administration. Attach the bottom label to the filter. If you have instrument management software the filter can be registered via the barcode. The TapFilter can now be put into use.

REPLACING THE FILTER CARTRIDGE

The filter must be replaced no later than 92 days after it was used for the first time. Replace the cartridge in any case if the water pressure is noticeably reduced. If the filter needs to be replaced early, this is generally not a result of a defect in the filter system, but rather an indication that the quality of the incoming water is inferior or that this tap is being used more than average. Follow the step-by-step plan on the fold-out page of these instructions to replace the cartridge (picture 7-10).

We recommend washing your hands thoroughly before replacement. Avoid contact with the outlet opening of the filter as much as possible. Remove the cartridge from the coupling using the little grey tool supplied. The non-return valve ensures that no contaminated water can flow out of the cartridge. A small amount of mains water may flow out of the coupling. The used cartridge is sealed and can be disposed of as regular waste. Remove the filter cartridge from the packaging. Attach the watertight 2-part date label supplied to the filter and write down

the date of first use and the replacement date (92 days later) on both labels. The top label is for your own administration. Attach the bottom label to the filter. If you have instrument management software the filter can be registered via the barcode. Place the new cartridge by pushing it onto the quick-connect coupling until you hear a click and the cartridge is firmly connected.

LIMITATION OF WARRANTY AND LIABILITY

X-Flow BV represents and warrants for the warranty period of one year that its products are free from substantial defects in materials and workmanship and conform to the specifications. X-Flow BV's warranties do not cover defects or deficiencies due to or arising from (1) normal wear and tear or improper, abnormal, or negligent handling, operation, maintenance, overloading, or use; (2) tampering, alteration, or repair by buyer or third parties without the prior written consent of X-Flow BV. The warranties specifically contained in this section are the only warranties provided and are expressly in lieu of all other warranties, express or implied, including – without limiting the generality of the foregoing – implied warranties of merchantability and fitness for a particular purpose, which are hereby disclaimed. In no event shall X-Flow BV or its Affiliates be liable for any indirect damages. X-Flow BV will repair or replace products that are not in conformity with the warranties as described above. Any complaints about defects in or non-conformity of the products must be submitted by the buyer to X-Flow BV in writing – specifying the defect or non-conformity in reasonable detail – within ten (10) business days of having received the relevant goods, failing which the right to complain shall lapse, except in respect of defects that the buyer could not reasonably have discovered within this time frame. The information and data contained in this document are based on our general experience and are believed to be correct. They are given in good faith and are intended to provide a guideline for the selection and use of our products. Since the conditions under which our products may be used are beyond our control, this information does not imply any guarantee of final product performance and we cannot accept any liability with respect to the use of our products. The quality of our products is guaranteed under our conditions of sale. Existing industrial property rights must be observed.

Manufactured by X-Flow BV
www.xflow.pentair.com
© X-Flow BV
All rights reserved

