

PREMIER SANITARY HOUSING

PFSH - 3/5/7 ROUND - 2" PORTS

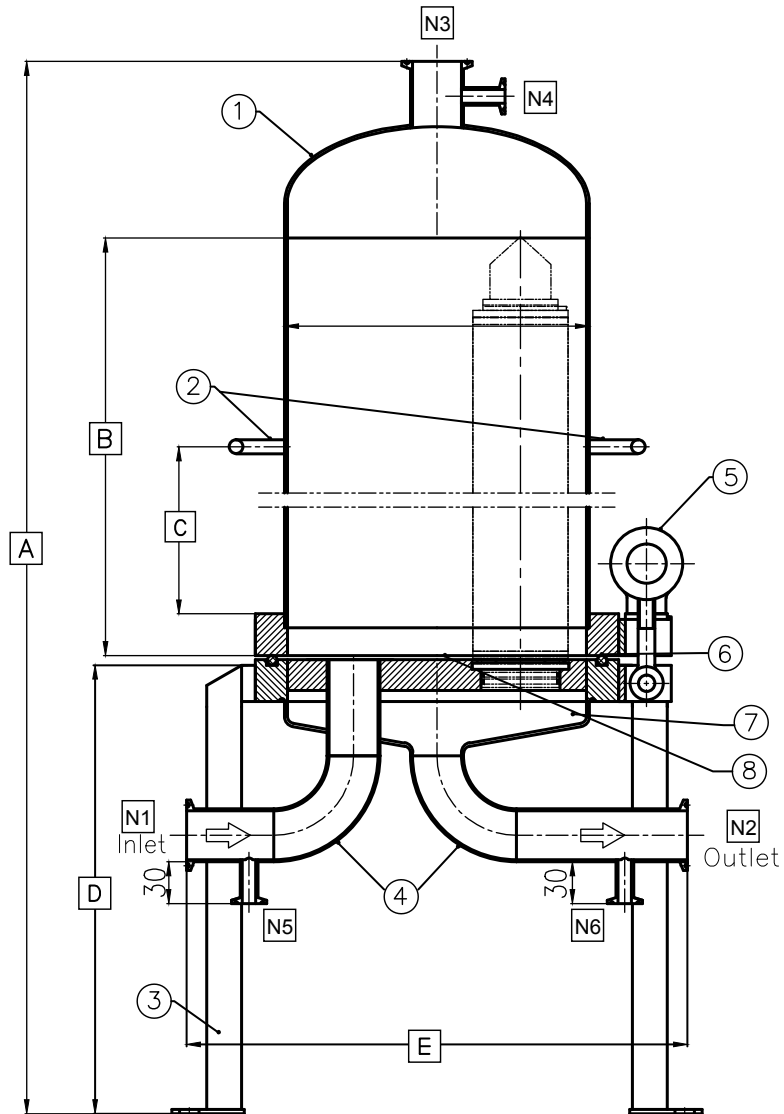

Top view 3 Round

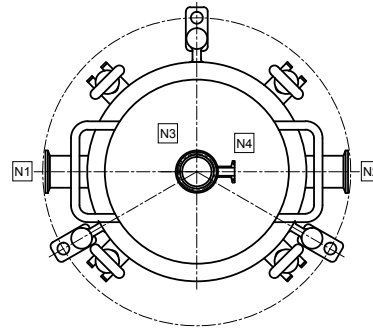

Top view 5 Round

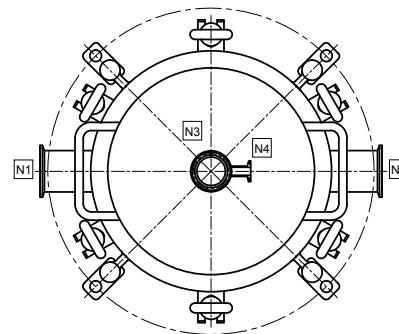

Top view 7 Round

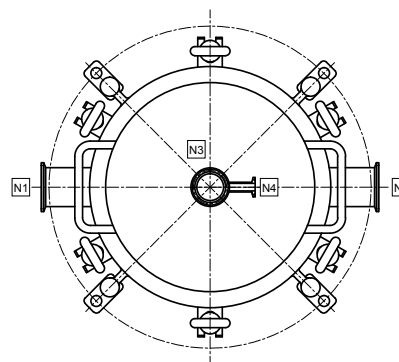

Overall Dimensions						
Part Number	To Accommodate Filter Qty x Length	A mm	B mm	C mm	D mm	E mm
PSFH-SEP-3-30-2	3 x 30"	1255	800	250	320	360
PSFH-SEP-5-30-2	5 x 30"	1285	800	250	342	420
PSFH-SEP-5-40-2	5 x 40"	1535	1050	250	342	420
PSFH-SEP-7-30-2	7 x 30"	1293	800	250	345	440
PSFH-SEP-7-40-2	7 x 40"	1543	1050	250	345	440

Port Details					
No.	Type	Size	No.	Type	Size
N1	Inlet	2" Tri-Clamp	N4	Vent	½" Tri-Clamp
N2	Outlet	2" Tri-Clamp	N5	Drain	½" Tri-Clamp
N3	Gauge Port	1½" Tri-Clamp	N6	Drain/ Sample Port	½" Tri-Clamp

Components					
No.	Name	Material	No.	Name	Material
1	Housing Body	316L	7	Housing Base	316L
2	Handle	304	8	226 Cartridge Locator Plate	316L
3	Legs- fixed (3 Round =3 5&7 Round =4)	304	Not Shown	Glycerine Filled Diaphragm Gauge, 11 bar, 1.5" Tri-Clover	316L
4	Inlet/Outlet pipe	316L	Not Shown	Tri-Clamps (x3)- for Vent & Drains	304
5	Swingbolt Assembly	304	Not Shown	Blanking Plates (x3)- for Vent & Drains	316L
6	O-Ring	EPDM			

Technical Information	Design Temperature	150°C
<ul style="list-style-type: none"> Pressure relief device should be installed on the outer piping by the customer to assure that pressure in the vessel can not exceed the design pressure indicated. Vent and Drain ports come with blanking plates and Tri-Clamps. All dimensions are approximate in mm. 	Maximum Operating Temperature	120°C
	Design Pressure	8 bar
	Hydrostatic Test Pressure	10 bar